

QUIETEX IS A GRANULAR MINERAL FILLER MADE FROM DALRIADAN CALCITIC LIMESTONE WHICH PROVIDES AN EXCELLENT SOUND INSULATION BETWEEN TIMBER FLOOR JOISTS.

Used in place of ash deafening, this cleaner product will improve fire, thermal and acoustic performance and is frequently used in the preservation industry for its non-irritant, dry and easy installation. It is free draining and solves floor construction problems such as leaks, access for refurbishment, repairs and replacement.

**IDEAL FOR**

- New build sound reduction
- Sound proofing in restoration of existing buildings

This product has been successfully and extensively used since 1966 and has been tested in situ by Napier University Department of Building and Surveying in new-build flat construction and in a grade A listed building refurbishment.

Quietex is available from all leading builders merchants in 20kg clear bags and when placed at a depth of 60mm will achieve an approximate density of 84kg/m<sup>2</sup>, which is in excess of the minimum 80kg/m<sup>2</sup> specified in the UK to Building Control Regulations.

**BUILDING CONTROL**

The Building Standards (Scotland) Regulations, 1990. Technical Standards: Regulation H2.3, b, 18.

- The airborne sound insulation tests were carried out in accordance with BS2750, part 4, 1980. The impact tests were carried out in accordance with BS 2750, part 7, 1980
- The Weighted Standardised Impact Sound Pressure Level (LnT,w) has been calculated for each impact test in accordance with BS5821: part 2, 1984
- The Building Standards (Scotland) Regulations, 1990. Technical Standards: Regulation D2.2. Floor constructions comply to one hour fire resistance

**TYPICAL NEW BUILD**

Building tested was a two storey flatted development in timber kit construction in Peterhead. Separating floor construction details as shown.

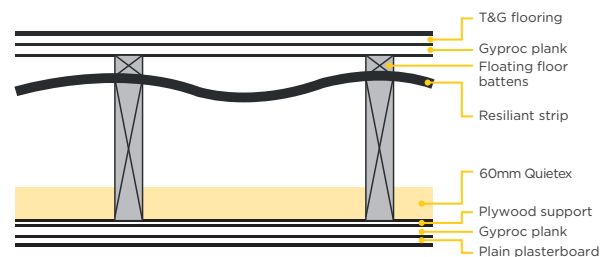

**TYPICAL REFURBISHMENT**

Building tested was The Jacobean Building, Virginia Street, Glasgow, a Grade A listed building refurbished with assistance from Historic Scotland. Separating floor construction details as shown.

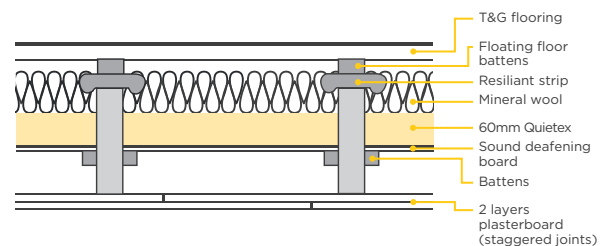

**FOR FURTHER DETAILS OR A SALES QUOTATION PLEASE CONTACT:**

**TEL: 0845 2707374**

Ethiebeaton Quarry, Monifieth, Angus, DD5 3RB.

enquiries.breedon@breedongroup.com

www.breedongroup.com

In keeping with our policy of continual product development, Breedon Group reserves the right to alter any specification shown. All products are derived from naturally occurring materials and as such colours depicted are as accurate as this and the limitation of the print process allows. All content is for guidance only with weights and measures being approximates.

All recommendations and suggestions made do not constitute a guarantee.

Breedon Group Head Office: Pinnacle House, Breedon Quarry, Breedon on the Hill, Derby DE73 8AP